

The PST Pot Stacker picks up pots from a conveyor belt and stacks them on a buffer belt.



The PST is characterized by its:

- Simple operation
- High mobility
- Compact size
- Short cycle times
- Suitability for use in a wide variety of situations
- Limited need for safeguards non-hazardous design

Use:

The PST is an extremely useful stacker. Any required product can be stacked simply by locating the stacker next to the belt, positioning a buffer belt by the stacker and that's it. Almost no adjustments are required.

Safe for production staff and the product:

Safety is promoted by the use of light-weight stacking arms that cannot exert a downward pressure. The pneumatic mechanism which swivels the arms exerts a limited force. If so required, unintended contact with the moving stacking arms can be prevented by placing a safety screen at the required location.

Principle:

The PST is designed on the basis of a double-action principle whereby one pot is stacked and the next pot is picked up at the same time. Consequently the stacker is designed to achieve short cycles with smooth movements in turn increasing the reliability and safety of the machine.

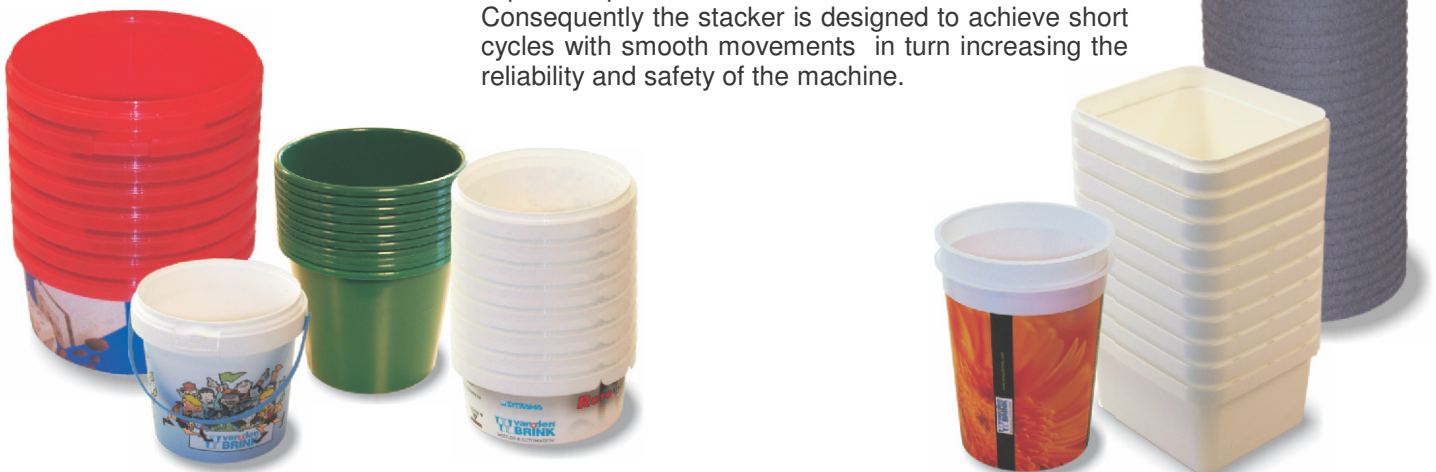

Specifications: PST Pot Stacker

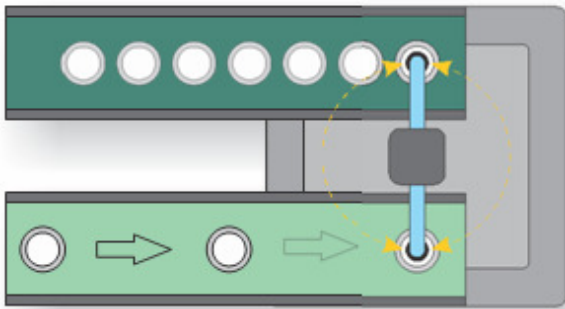

Stacker stacking one piece in each cycle.
The stacking capacity is 1200 pieces per hour.
The feed and discharge belts can be aligned at any required angle.

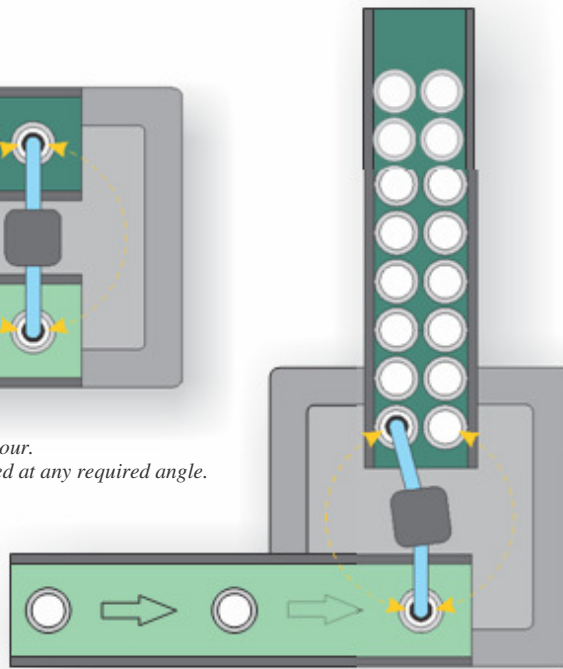

This stacker is also stacking one piece in each cycle. The stacking capacity is 1200 pieces per hour.
The same version is now used to stack two rows.
The feed belt can be aligned at any angle.

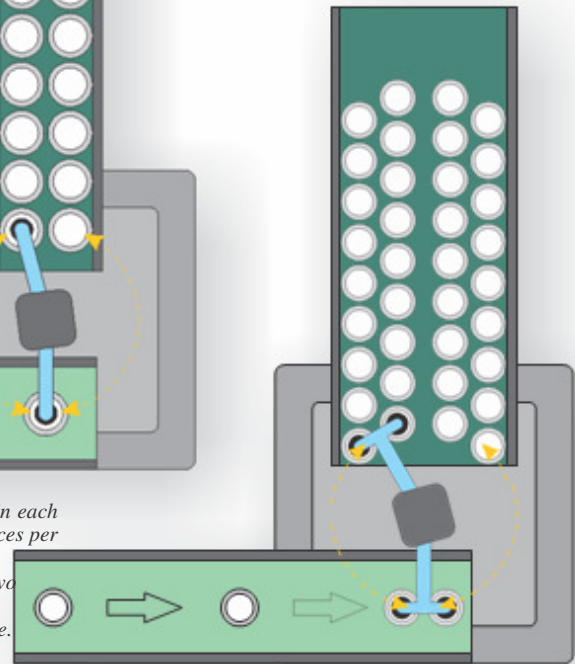

Stacker stacking two pieces in each cycle.
The stacking capacity is 2400 pieces per hour. This version is used to stack four rows.
The feed belt can be aligned at any angle.

Specifications:

Stacker:

height: 1,900
length: 800
breadth: 800

Stacking diameter: Ø 500-1000

Cycle: 3 sec.

single: 1,200 pieces per hour

double: 2,400 pieces per hour

triple: 3,600 pieces per hour

Working heights:

pick up: 300 - 1,000

set down: 500 - 1,000

Belt lengths: as required

Buffer capacity: 1 - 6 rows

Stacking height: product-dependent

Product:

type: pots, tubs, lids

size: up to 300 mm.

weight: up to 0.5 kg

Pick-up head: Suction cups

Control system: PLC

Operation: Consol panel /

touchscreen

Safeguard: Screen

Note: The specifications are subject to change

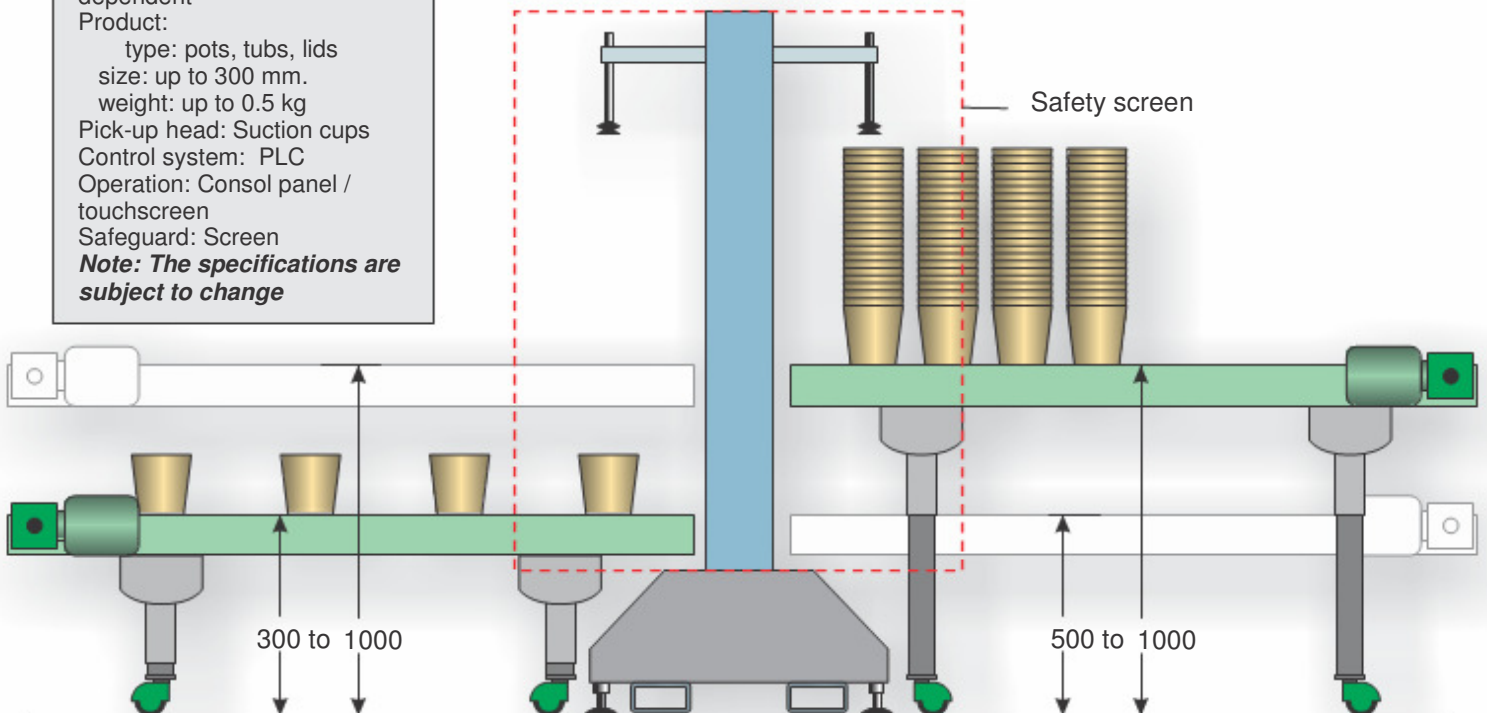

Van den Brink b.v.
Molenweg 10b
6732BL Harskamp Holland
Tel: 0031-318 - 452500
Fax: 0031-318 - 456378
E-mail: info@vandenbrinkbv.com
Internet: www.vandenbrinkbv.com

The heights of the belts can be adjusted independently to any height between 500 and 1000 mm.
The stacking height can be set using the display.
The maximum height depends on the stability of the stack and the height of the belt.